



Quick Start Guide

USB 3.0 Dual 2K@60Hz Portable Dock



www.wavlink.com/en_us/WL-UG39DH2
Scan the QR code or load the link for Quick Start Guide and Driver downloading

WL-UG39DH2

WAVLINK (@WavlinkOfficial)
WAVLINK SUPPORT (@WavlinkTechSupport)

Safety Instructions

Always read the safety instructions carefully. Keep this Quick Start Guide for future reference. Keep this equipment away from humidity. If any of the following situation arises, get the equipment checked by a service technician:

- The equipment has been exposed to moisture.
- The equipment has been dropped and damaged.
- The equipment has obvious sign of breakage.
- The equipment has not been working well or you cannot get it work according to Quick Start Guide.

Copyright Statement

No part of this publication may be reproduced in any form by any means without the prior written permission. Other trademarks or brand names mentioned herein are trademarks or registered trademarks of their respective companies.

Disclaimer

Information in this document is subject to change without notice. The manufacturer does not make any representations or warranties (implied or otherwise) regarding the accuracy and completeness of this document and shall in no event be liable for any loss of profit or any commercial damage, including but not limited to special, incidental, consequential, or other damage.

WEEE Directive & Product Disposal

At the end of its serviceable life, this product should not be treated as household or general waste. It should be handed over to the applicable collection point for the recycling of electrical and electronic equipment or returned to the supplier for disposal.

In the Box

- USB 3.0 Dual 2K@60Hz Portable Dock
- USB-A to USB-C Converter
- Micro-B to USB-A Power Cable
- Quick Start Guide

Specifications

- Plug and play, no external power adapter required.
- Slim 2 in 1 combo mini dock with foldable integrated USB-A cable.
- VGA + HDMI (dual) output up to 2048 x 1152@60Hz.
- Detachable mini hub with integrated SD and micro SD card readers.
- Integrated two USB 3.0 (5Gbps) Type-A ports.
- Integrated one Gigabit Ethernet port supports 10/100/1000Mbps speeds.
- Support Extended/Mirrored Video Modes.
- Support Windows, Mac OS X.

Overview



1. Gigabit Ethernet Port
2. USB Power Port
3. USB IN Port
4. Micro SD Port
5. SD Port
6. SuperSpeed USB 3.0 Port
7. SuperSpeed USB 3.0 Port
8. 2K HDMI Output Port
9. 2K VGA Output Port

Driver Installation

The DisplayLink driver will be automatically installed when your Windows 10/11 host has connected to the Dock and is on the Internet, if the automatic installation doesn't happen, please enter the www.wavlink.com/en_us/WL-UG39DH2 to find and download the corresponding driver for this Dock and install it as the following steps:

For Windows

1. Locate the downloaded folder and double-click the driver file you just downloaded.
2. If there is no DisplayLink Driver in your Windows computer, open the file and then follow guide to install the Driver. If your Windows host has ever installed the Driver, open the file and then click Upgrade.

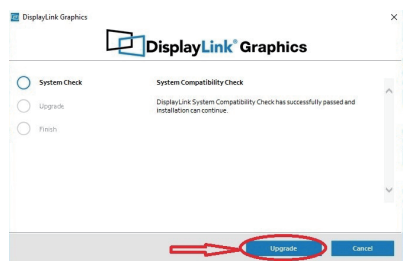

4

3. Please wait patiently for the complete of the installation. After finishing installation, click **Finish**.

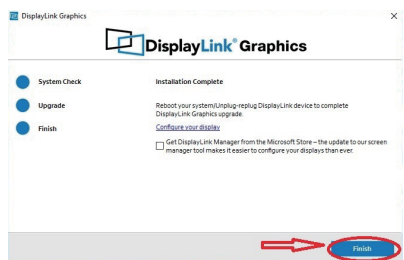

5

For Mac

1. Double-click the driver file you just downloaded, navigate to the **Install DisplayLink Manager** window, click **Continue**.

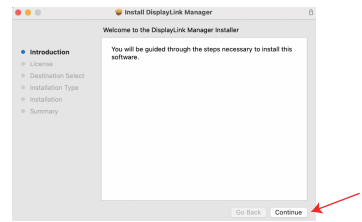

2. Click **Continue** to the next window, then click **Agree**.

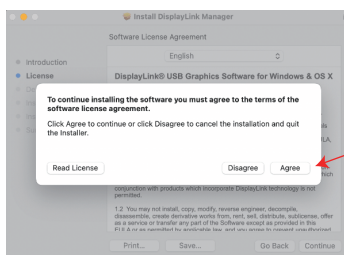
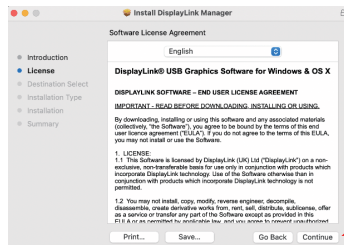

6

3. Click **Install** and choose **Use Password...**, then enter the screen password and click **Install Software**.

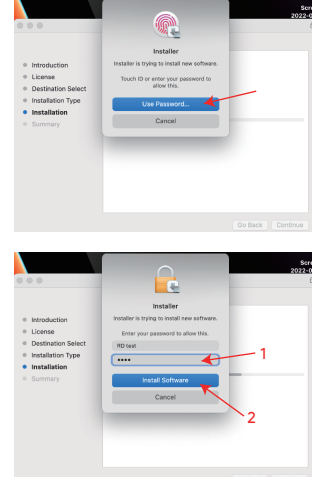

4. Please wait patiently for the installation to complete then click **Close**.

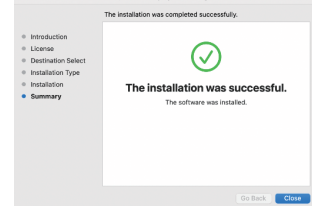

7

5. If you have enabled notifications from DisplayLink Manager, it will remind you to allow screen recording when it detects that this permission is missing.

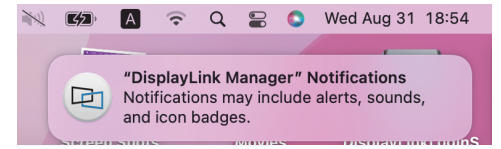

6. If you didn't get the notification from DisplayLink Manager, please click **Go** in the function bar at the top left of screen, then select **Applications** and click **DisplayLink Manager**.

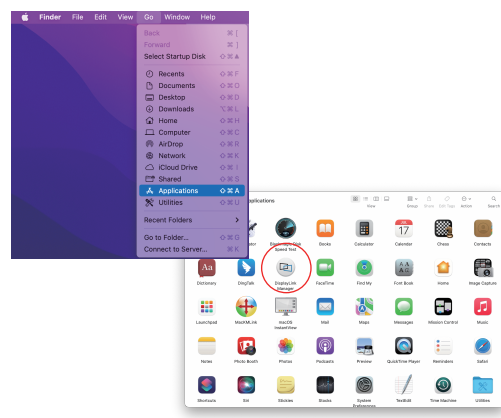

8

7. Click the **DisplayLink Graphics** icon in the function bar at the top right of the screen, and the notification will also appear in the DisplayLink Manager window. A warning is found here, you should allow the screen recording permission for DisplayLink Manager.

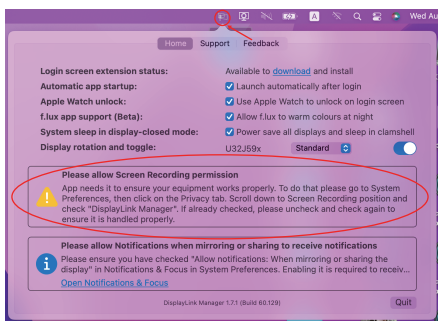

8. Click the **Apple icon** -> **System Preferences**, then double click **Security & Privacy**.



9

9. Enable **Screen Recording** to allow the **DisplayLink Manager** application to capture pixels and send them to your USB peripheral:

- 9.1 Select **Screen Recording** in **Privacy** tab.

- 9.2 Click the **lock** icon at the bottom left of the window to unlock.

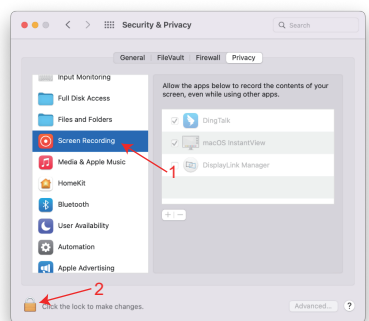

10

10. When the small window pops up, choose a password or use your fingerprint to unlock.

- 10.1 If you use password to unlock, and click **Use Password**, then enter your password and choose **Unlock**.

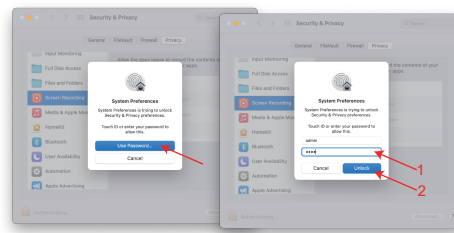

- 10.2 If you use fingerprint to unlock, it will jump directly to the next step.

11. Check the **DisplayLink Manager** in the right list.

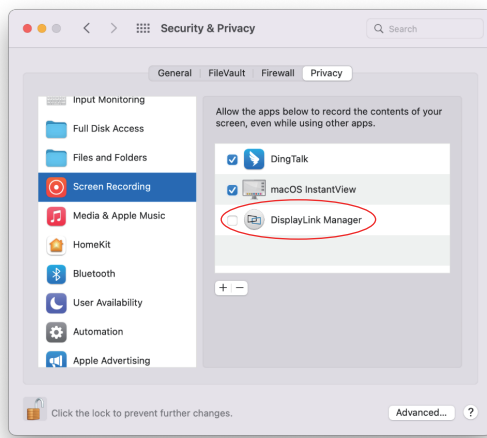

11

12. Click **Quit & Reopen** to restart the driver, then you can click the **DisplayLink Graphics** icon in the function bar at the top right of the screen to ensure whether the warning has been lifted and whether the driver can work properly.

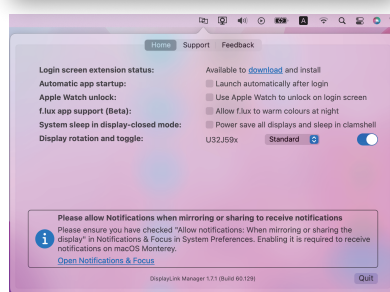
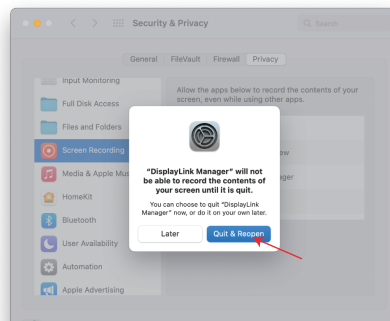

12

Hardware Installation

For Windows

Mode One (Data Transfer)

- Step 1: Connect the Mini Dock to a compatible computer.

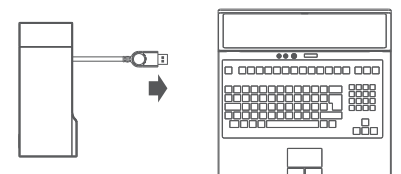

- Step 2: ① Attach USB peripherals to the Mini Dock with Card Reader Combo.

Pic 1

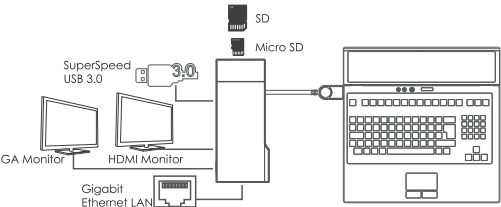

13

- ② Attach more USB peripherals to the Mini Dock without Card Reader Combo.

Pic 2

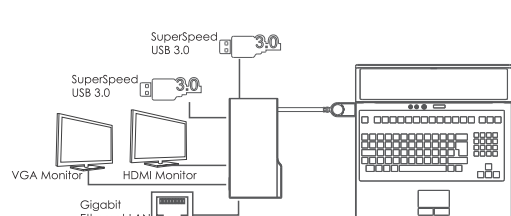

Mode Two (Data Transfer and USB Power)

- Step 1: Connect the Mini Dock to a compatible computer.

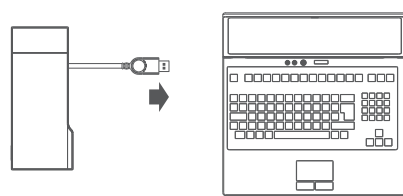

14

- Step 2: Connect the Mini dock to the external power adapter via **Micro-B to Type-A Power Cable**(Cable ②).

Pic 2

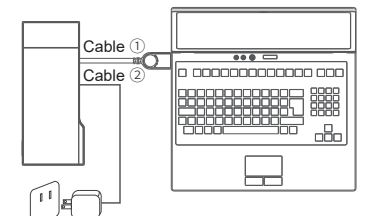

Step 3:

- ① Attach USB peripherals to the Mini Dock with Card Reader Combo.

Pic 1

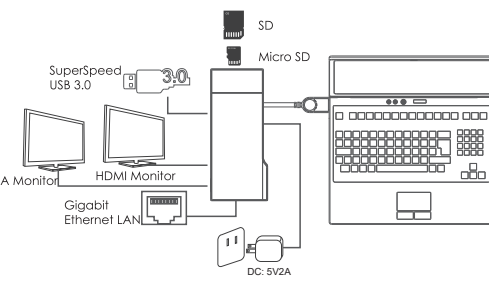

15

- ② Attach USB peripherals to the Mini Dock without Card Reader Combo.

Pic 2

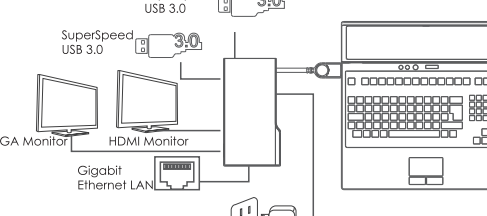

For Mac OS

You can now connect up to 4 additional displays with an extra dock.

1. Install the driver.
2. Connect MacBook Pro to the powered dock.
3. Connect the Mini dock to the external **Power Adapter** via **Micro-B to Type-A Power Cable**.
4. Connect monitors to the dock via standard HDMI and VGA cables.

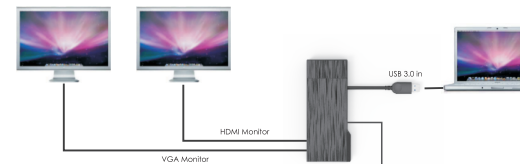

16

Card Reader Combo Connection

This USB-A 3.0 card reader combo supports SD/Micro SD read and write at the same time, and also can download and store items in high transmission rate. You can attach more USB peripherals to this Card Reader Combo.



Configuration

Before configuring the settings, please make sure this docking station has been connected to your laptop and monitors correctly.

For Windows

1. Right-click->**Display settings**.

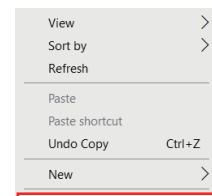

17

2. In **"Display"**, you can enjoy different operations of duplicating, extending and rotating on your monitors.

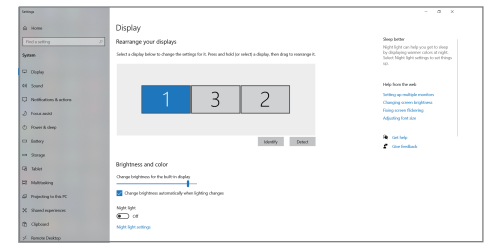

For Mac OS X12 or Below

1. Click **Apple icon**->**About This Mac**.

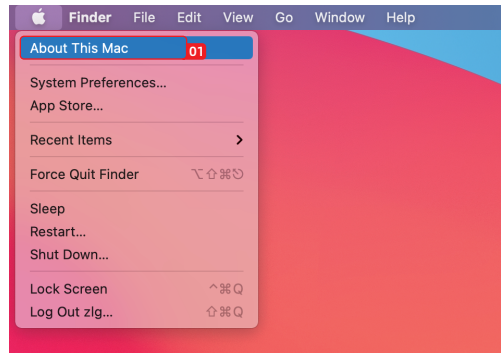

18

2. Click **Displays**->**Displays Preferences**.

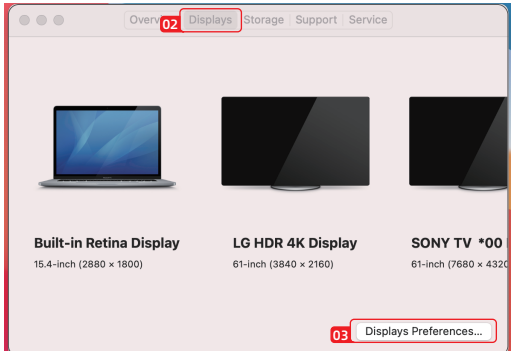

3. Select **"Display"** from the list, then you can enjoy different operations of mirroring, expanding and rotating on your monitors.

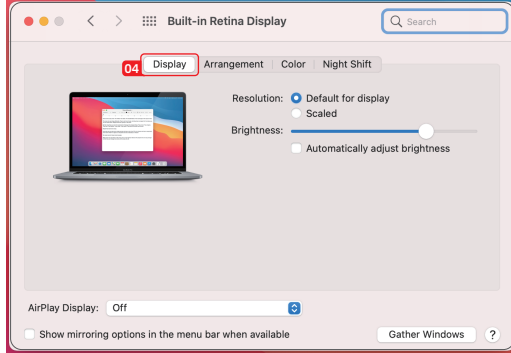

19

4. Or click **"Gather Windows"** to gather all connected displays and make separate settings.

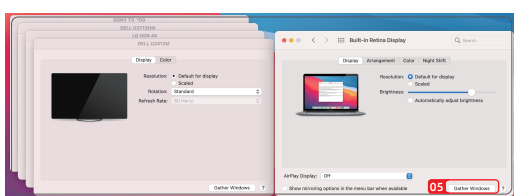

For Mac OS X13

1. Click **Apple icon**-> **About This Mac**

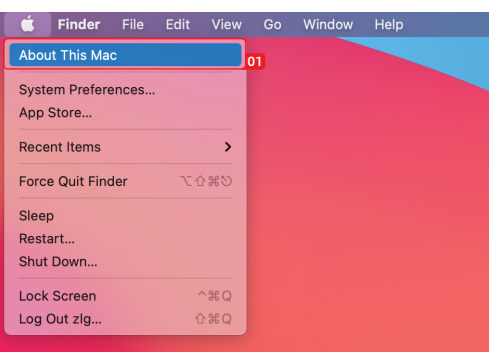

20

2. Click **"More Info..."**

3. Select **"Displays"** from the list, then you can enjoy different operations of mirroring, expanding and rotating on your monitors.

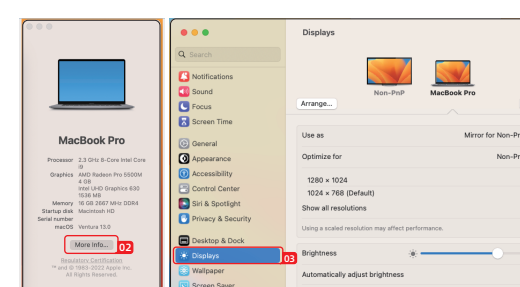

21



Thanks for purchasing
WAVLINK product!

Official website: www.wavlink.com
Technical support: support@wavlink.com