

WAVLINK

see the world

Quick Start Guide

USB-C to HDMI Dual Display Adapter
with 95W Power Delivery



www.wavlink.com/en_us/WL-UHP510-MAX

Scan the QR code or load the link
for Quick Start Guide downloading



WAVLINK (@WavlinkOfficial)
WAVLINK SUPPORT (@WavlinkTechSupport)

WL-UHP510 MAX

Safety Instructions

Always read the safety instructions carefully.

Keep this Quick Start Guide for future reference.

Keep this equipment away from humidity.

If any of the following situation arises, get the equipment checked by a service technician:

- The equipment has been exposed to moisture.
- The equipment has been dropped and damaged.
- The equipment has obvious sign of breakage.
- The equipment has not been working well or you cannot get it work according to Quick Start Guide.

Copyright Statement

No part of this publication may be reproduced in any form by any means without the prior written permission. Other trademarks or brand names mentioned herein are trademarks or registered trademarks of their respective companies.

Disclaimer

Information in this document is subject to change without notice. The manufacturer does not make any representations or warranties (implied or otherwise) regarding the accuracy and completeness of this document and shall in no event be liable for any loss of profit or any commercial damage, including but not limited to special, incidental, consequential, or other damage.

WEEE Directive & Product Disposal



At the end of its serviceable life, this product should not be treated as household or general waste. It should be handed over to the applicable collection point for the recycling of electrical and electronic equipment, or returned to the supplier for disposal.

Introduction

This USB-C to Dual HDMI Adapter supports maximum 4K@60Hz resolution in single display. It can extend your image/video from your phone or notebook to an external display such as the Projector, HDMI-based monitor. Whether you need to extend a monitor for work, stock market or conference, this adapter is of great help to assist you with your task.

Features

- Support single or dual 4K@60Hz display.
- Support 95W power delivery for your host Laptops.
- The HDMI ports can extend your display up to two HDMI monitors.
- Mirror and Extend modes offer more operational possibilities.
- Compatible with Type-C Alt-mode Laptops.
- No external power adapter or driver needed.

System Requirements

- Microsoft Windows 7/8/10/11
- Mac OS 10.8 or later (Can extend a different display ONLY)

Display Resolution

Systems Scenarios	Windows	Mac OS
Single Display	4K@60Hz	4K@60Hz
Dual Display	Dual 4K@60Hz(DP1.4) 4K@60Hz+4K@30Hz(DP1.2)	Dual 4K@60Hz (Mirror)

Note:

1. When connected with Apple computer, our product supports 1 external monitor.
2. Mac OS is Single-Stream Transport mode, so only one video source can be output such as ABB (A is the primary display).

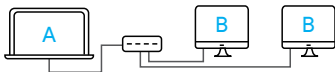

In the Box

- 1 x USB-C to HDMI Dual Display Adapter
- 1 x Quick Start Guide

Operation

Connect the adapter to the laptop or phone with USB-C port, then connect the adapter to the TV, Projector or other HDMI-based monitors with HDMI port.

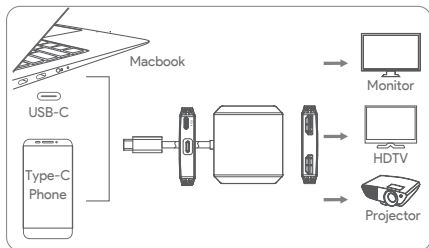

Need help?

We're here for you!



Online support: [wavlink.com](https://www.wavlink.com)

Available Mon-Fri 8:30 am-5:30pm (UTC+8)



support@wavlink.com

Available Mon-Fri 8:30 am-5:30pm (UTC+8)



+1 8889730883 (US Local)

Mon-Fri 9:00 am - 10:00 pm (UTC-5)

www.wavlink.com



**Thank you for purchasing
WAVLINK product!**