

Safety Instructions

Always read the safety instructions carefully.

Keep this Quick Start Guide for future reference.

Keep this equipment away from humidity.

If any of the following situation arises, get the equipment checked by a service technician:

- The equipment has been exposed to moisture.
- The equipment has been dropped and damaged.
- The equipment has obvious sign of breakage.
- The equipment has not been working well or you cannot get it work according to Quick Start Guide.

Copyright Statement

No part of this publication may be reproduced in any form by any means without the prior written permission.

Other trademarks or brand names mentioned herein are trademarks or registered trademarks of their respective companies.

Disclaimer

Information in this document is subject to change without notice.

The manufacturer does not make any representations or warranties (implied or otherwise) regarding the accuracy and completeness of this document and shall in no event be liable for any loss of profit or any commercial damage, including but not limited to special, incidental, consequential, or other damage.

WEEE Directive & Product Disposal



At the end of its serviceable life, this product should not be treated as household or general waste. It should be handed over to the applicable collection point for the recycling of electrical and electronic equipment, or returned to the supplier for disposal.

Introduction

The USB3.0 to HDMI adapter is a multi-mode adapter that supports maximum 4K resolution; it can extend your image/video to an external display such as the projector, HDTV, or HDMI-based monitor. Whether you need to extend a monitor for work, stock market, gaming, or conference, this adapter is of great help to assist you with your task.

Features

- 4K HDMI port extends your display to an HDMI based monitor.
- The compact and portable design makes it easy to carry around.
- USB3.0 and powerful GPU ensure stable video transmission.
- Resolution supports: from 640x480@60Hz to 3840x2160@30Hz.
- Mirror and Extend modes offer more operational possibilities.
- Content Adaptive Technology applied in GPU decreases CPU loading.

System Requirement

- Microsoft Windows 7/8/8.1/10 or higher
- Mac OS 10.10.x or higher, Apple M1 or later
- CPU Processor: Core i5 or higher
- RAM: 4GB
- Monitor that supports 4K UHD

In the Box

- 1 x USB 3.0 to HDMI 4K Display Adapter
- 1 x HDMI to DVI Converter
- 1 x Quick Start Guide

Driver Installation

Before using this Dock, please make sure the latest PC/laptop drivers have been installed. If drivers cannot be installed automatically, please visit www.wavlink.com/en_us/WL-UG7601HC or enter www.wavlink.com and click **SUPPORT > Driver > WL-UG7601HC** to find and install it.

For Windows

1. After extracting the file downloaded, click **SMIUSBDisplaySW (.exe)** in the extracted file.

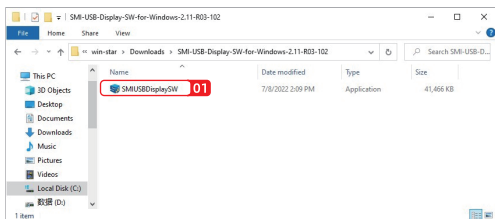

2. Click **UPDATE**.

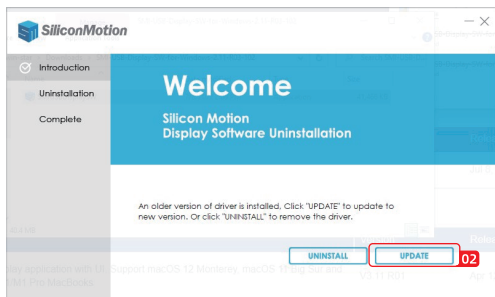

3. Click **EXIT** to finish the installation process.

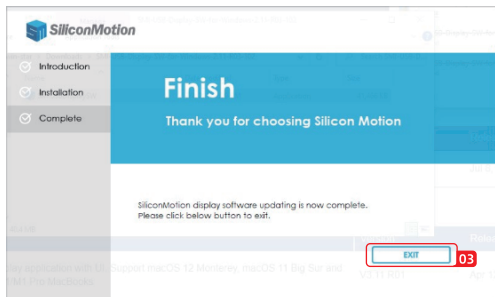

For Mac OS

Download the Silicon Motion InstantView application for Mac OS found here: www.wavlink.com/en_us/WL-UG7601HC to find and manually install it.

1. Double click on the file you downloaded to start the application installer.

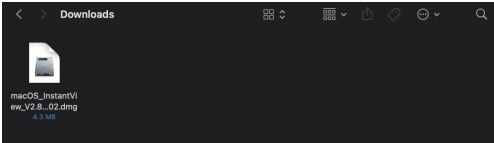

2. Drag the **macOS InstantView** application icon into the **Applications** folder in the open window.

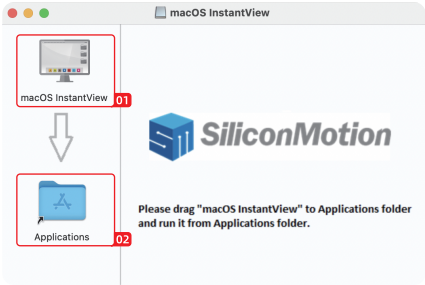

3. Navigate to your Launchpad or Applications folder to find the **macOS instantView** and double-click to launch it.

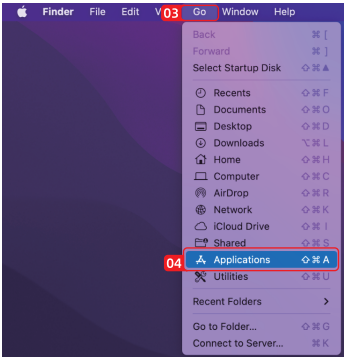



4. Click **Open**.

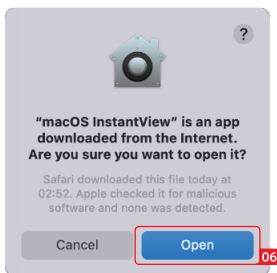

5. Click **Open System Preferences**. (Note: this should automatically open the **Security and Privacy** section , but if it does not, you can manually open the **Security and Privacy settings**.)

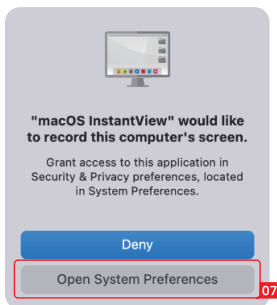

6. Click on the gold pad lock at the bottom of the application window to enable changes.

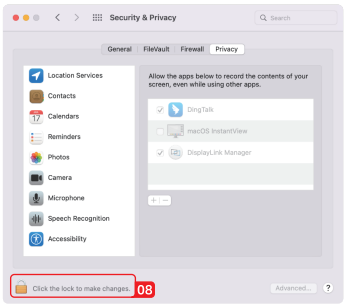

7. If prompted, enter your password and click the **Unlock** button:

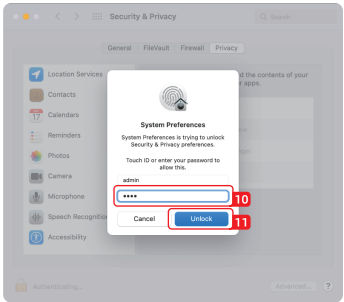
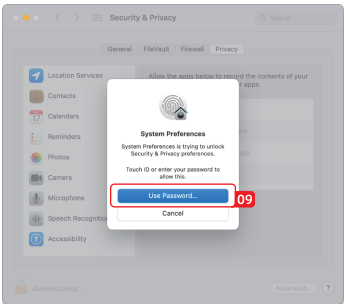

8. Click to place a check mark next to the macOS InstantView entry:

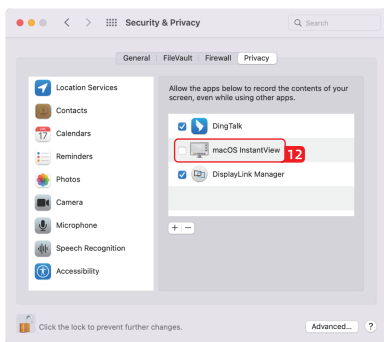

9. You will be prompted to **Quit and Reopen** the InstantView application in order for the change to take effect. Please do so:

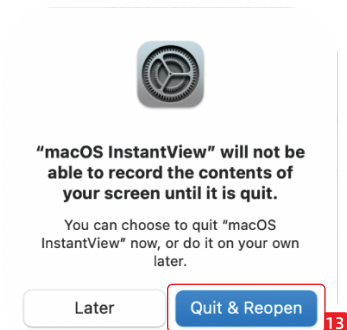

10. The software has now been installed and you may connect your graphics adapter or docking station.

11. When the computer is connected to the docking station for the first time, the following window will appear after the driver is started. You can choose to disconnect or mirror the screen according to your personal usage. In addition, you can also close this window and go to the system settings to set the screen.

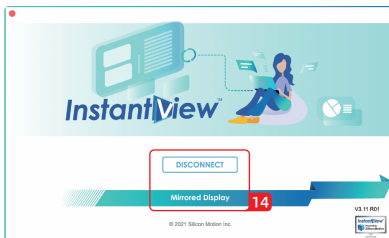

Display Mode Setting

For Windows Users

1. Right-click at any spot on your desktop and select **“Display settings”**.

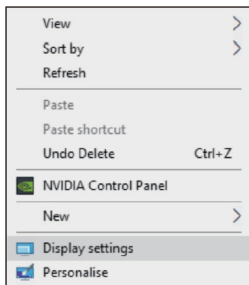

2. In section **“Display”**, please select either monitor 1 or monitor 2.

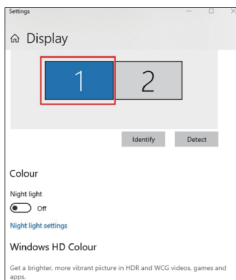

3. Scroll down to the **“Multiple displays”**, and select the mode in the drop-down list that is fit for your need.

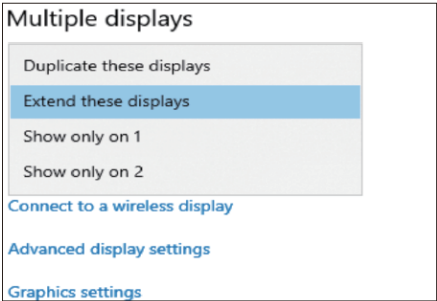

For Mac Users

1. Select **“System Preferences”** and choose **“Displays”**.

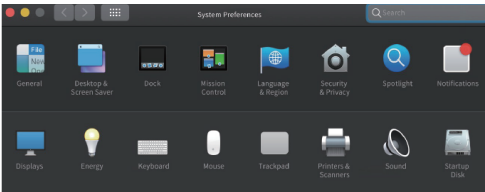

2. Click on **“Arrangement”** to change the position of displays currently connected.

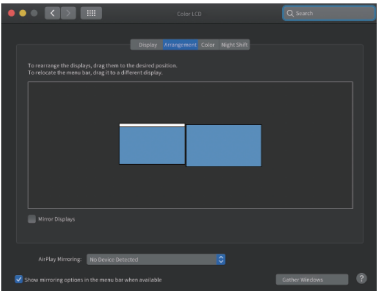

Extend Mode

3. To use the mirror mode, you have to mark the **“Mirror Displays”** box below the central icon.

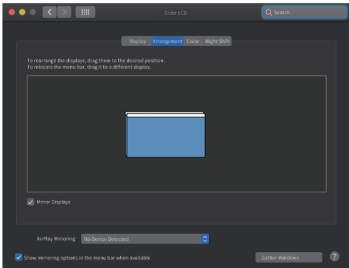

Mirror Mode

Notice:

Due to privacy policy applied in Mac, you may experience the following issue:



Select **“System Preferences”** and choose **“Security & Privacy”**, click on **“Open Anyway”** to approve of the driver installation.

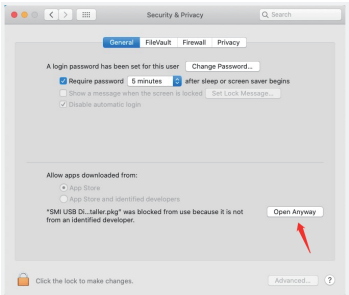

Supported Resolution

Windows 10

3840×2160	30Hz
2560×1440	60Hz
1920×1080	60Hz
1680×1050	60Hz
1600×1200	60Hz
1600×900	60Hz
1440×1050	60Hz
1440×900	60Hz
1280×1024	60Hz
1280×800	60Hz
1280×720	60Hz
1152×864	60Hz
1024×768	60Hz
800×600	60Hz
720×480	60Hz
640×480	60Hz

Mac OSX

3840×2160	30Hz
2560×1440	60Hz
1920×1080	60Hz
1920×1080	30Hz
1600×900	60Hz
1280×720	60Hz

The exact list of supported resolutions depends on your monitor performance.

Need help?

We're here for you!



Online support: wavlink.com

Available Mon-Fri 8:30 am-5:30pm (UTC+8)



support@wavlink.com

Available Mon-Fri 8:30 am-5:30pm (UTC+8)



+1 8889730883 (US Local)

Mon-Fri 9:00 am - 10:00 pm (UTC-5)

www.wavlink.com



**Thank you for purchasing
WAVLINK product!**